

DN	A	B	C	D	E	Article 304	
DN10	14.0	90.0	17.2	17.7	60.0	143100172	143100174
DN15	14.0	95.0	21.3	22.0	65.0	143100212	143100214
DN20	16.0	105.0	25.0	26.0	75.0	143100252	143100254
DN20	16.0	115.0	25.0	26.4	85.0	143100262	143100264
DN20	16.0	105.0	26.9	27.6	75.0	143100272	143100274
DN25	16.0	115.0	30.0	31.0	85.0	143100302	143100304
DN25	16.0	115.0	33.7	34.5	85.0	143100342	143100344
DN40	16.0	150.0	38.0	39.0	110.0	143100382	143100384
DN32	16.0	140.0	42.4	43.1	100.0	143100422	143100424
DN40	16.0	150.0	48.3	49.5	110.0	143100482	143100484
DN50	18.0	165.0	50.8	51.9	125.0	143100512	143100514
DN50	18.0	165.0	54.0	55.1	125.0	143100542	143100544
DN50	18.0	165.0	60.3	61.1	125.0	143100602	143100604
DN65	18.0	185.0	63.5	64.6	145.0	143100632	143100634
DN65	20.0	185.0	70.0	71.1	145.0	143100702	143100704
DN65	18.0	185.0	76.1	77.1	145.0	143100762	143100764
DN80	20.0	200.0	84.0	85.5	160.0	143100842	143100844
DN80	20.0	200.0	88.9	90.3	160.0	143100892	143100894
DN100	20.0	220.0	101.6	103.2	180.0	143101022	143101024
DN100	20.0	220.0	104.0	105.6	180.0	143101042	143101044
DN100	20.0	220.0	108.0	109.6	180.0	143101082	143101084
DN100	20.0	220.0	114.3	115.9	180.0	143101142	143101144
DN125	22.0	250.0	129.0	130.8	210.0	143101292	143101294
DN125	22.0	250.0	139.7	141.6	210.0	143101402	143101404
DN150	22.0	285.0	154.0	156.1	240.0	143101542	143101544
DN150	22.0	285.0	168.3	170.5	240.0	143101682	143101684
DN200	24.0	340.0	204.0	206.8	295.0	143102042	143102044
DN200	24.0	340.0	219.1	221.8	295.0	143102192	143102194
DN250	26.0	395.0	256.0	259.2	350.0	143102562	143102564
DN250	26.0	395.0	273.0	276.2	350.0	143102732	143102734
DN300	26.0	445.0	304.0	307.7	400.0	143103042	143103044
DN300	26.0	445.0	306.0	309.7	400.0	143103062	143103064
DN300	26.0	445.0	323.9	327.6	400.0	143103242	143103244
DN350	28.0	505.0	355.6	359.7	460.0	143103562	143103564
DN400	32.0	565.0	406.4	411.0	515.0	143104062	143104064
DN450	38.0	615.0	457.2	462.3	565.0	143104572	143104574
DN500	38.0	670.0	508.0	513.6	620.0	143105082	143105084
DN600	44.0	780.0	609.6	615.7	725.0	143106102	143106104

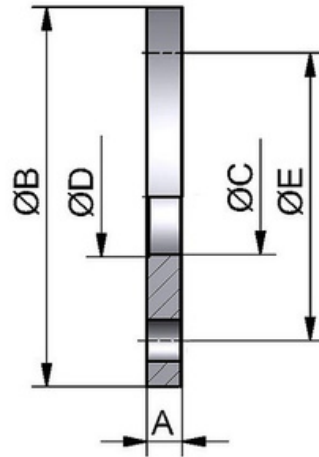

Article properties

According to	EN 1092-1 Type 01 (previously DIN 2576)
Field of application	Chemistry & General industry
Maximum pressure of 140°C when right gasket is used	PN6 / PN10 / PN16 / PN40
Material According to EN 10088-1	304 / 1.4301 and 316L / 1.4404
Finishing general	Unfinished Ra 25µm
Certification	EN10204/3.1 Certificate