

DN	A	B 90.0	C	D	E	Article	304
DN10	35.0	95.0	13.6	17.2	60.0	148100172040	148100174040
DN15	38.0	95.0	16.0	20.0	65.0	148100202040	148100204040
DN15	38.0	105.0	17.3	21.3	65.0	148100212040	148100214040
DN20	40.0	105.0	20.4	25.0	75.0	148100252040	148100254040
DN20	40.0	115.0	22.3	26.9	75.0	148100272040	148100274040
DN25	40.0	115.0	24.8	30.0	85.0	148100302040	148100304040
DN25	40.0	140.0	28.5	33.7	85.0	148100342040	148100344040
DN32	42.0	140.0	32.8	38.1	100.0	148100382040	148100384040
DN32	42.0	150.0	37.2	42.4	100.0	148100422040	148100424040
DN40	45.0	150.0	39.3	44.5	110.0	148100452040	148100454040
DN40	45.0	165.0	43.1	48.3	110.0	148100482040	148100484040
DN50	45.0	165.0	50.0	54.0	125.0	148100542016	148100544016
DN50	45.0	165.0	54.5	60.3	125.0	148100602016	148100604016
DN50	48.0	185.0	54.5	60.3	125.0	148100602040	148100604040
DN65	45.0	185.0	70.3	76.1	145.0	148100762016	148100764016
DN65	52.0	200.0	70.3	76.1	145.0	148100762040	148100764040
DN80	50.0	200.0	80.0	84.0	160.0	148100842016	148100844016
DN80	50.0	200.0	82.5	88.9	160.0	148100892016	148100894040
DN80	58.0	220.0	82.5	88.9	160.0	148100892040	148101044016
DN100	52.0	220.0	100.8	108.0	180.0	148101082016	148101144016
DN100	52.0	235.0	107.1	114.3	180.0	148101142016	148101144040
DN100	65.0	250.0	107.1	114.3	190.0	148101142040	148101294016
DN125	55.0	270.0	131.7	139.7	210.0	148101402016	148101404016
DN125	68.0	285.0	131.7	139.7	220.0	148101402040	148101404040
DN150	55.0	285.0	150.0	159.0	240.0	148101592016	148101594016
DN150	55.0	340.0	159.3	168.3	240.0	148101682016	148101684016
DN200	62.0	340.0	206.5	219.1	295.0	148102192010	148102194010
DN200	62.0	395.0	206.5	219.1	295.0	148102192016	148102194016
DN250	68.0	405.0	260.4	273.0	350.0	148102732010	148102734010
DN250	70.0	445.0	260.4	273.0	355.0	148102732016	148102734016
DN300	68.0	460.0	309.7	323.9	400.0	148103242010	148103244010
DN300	78.0	505.0	309.7	323.9	410.0	148103242016	148103244016
DN350	68.0	520.0	341.4	355.6	460.0	148103562010	148103564010
DN350	82.0	565.0	339.6	355.6	470.0	148103562016	148103564016
DN400	72.0	580.0	392.2	406.4	515.0	148104062010	148104064010
DN400	85.0	670.0	390.4	406.4	525.0	148104062016	148104064016
DN500	75.0	780.0	493.8	508.0	620.0	148105082010	148105084010
DN600	80.0	895.0	595.8	610.0	725.0	148106102010	148106104010
DN700	80.0	1015.0	695.0	711.0	840.0	148107112010	148107114010
DN800	90.0		797.0	813.0	950.0	148108132010	148108134010

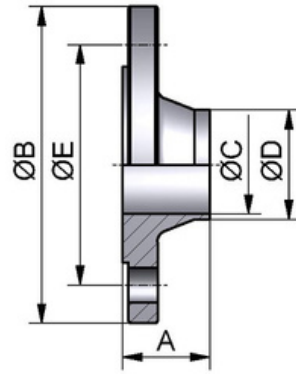

Article properties

According to	EN 1092-1 Type 11 (previously DIN 2633)
Field of application	Chemistry & General industry
Maximum pressure of 140°C when right gasket is used	PN6 / PN10 / PN16 / PN25 / PN40
Material According to EN 10088-1	304 / 1.4301 and 316L / 1.4404
Finishing general	Unfinished Ra 25µm
Certification	EN10204/3.1 Certificate