

Hygienic 3A stainless steel Levelling feet in various designs. Made entirely of stainless steel or with NBR or EPDM foot plate. With or without fixing lip. Essential in environments where hygiene is a top priority, such as in the pharmaceutical, chemical and food industries.

DN	A	B	C	D	E	Article 304
M12x140	188	140	M12	48	50	7131214005020
M12x140	188	140	M12	48	50	7131214005030
M12x140	191	140	M12	51	60	7131214006020
M12x140	191	140	M12	51	60	7131214006030
M12x147	195	147	M12	48	50	7131214705020
M12x147	195	147	M12	48	50	7131214705030
M12x190	238	190	M12	48	50	7131219005020
M12x190	238	190	M12	48	50	7131219005030
M12x190	241	190	M12	51	60	7131219006020
M12x190	241	190	M12	51	60	7131219006030
M16x140	188	140	M16	48	50	7131614005020
M16x140	188	140	M16	48	50	7131614005030
M16x140	191	140	M16	51	60	7131614006020
M16x140	191	140	M16	51	60	7131614006030
M16x190	238	190	M16	48	50	7131619005020
M16x190	238	190	M16	48	50	7131619005030
M16x190	241	190	M16	51	60	7131619006020
M16x190	241	190	M16	51	60	7131619006030
M16x190	246	190	M16	56	100	7131619010020
M20x140	188	140	M20	48	50	7132014005020
M20x140	188	140	M20	48	50	7132014005030
M20x140	191	140	M20	51	60	7132014006020
M20x190	238	190	M20	48	50	7132019005020
M20x190	238	190	M20	48	50	7132019005030
M20x190	241	190	M20	51	60	7132019006020
M20x190	241	190	M20	51	60	7132019006030
M16x140	193	140	M16	53	80	7131614008020
M24x190	243	190	M24	53	80	7132419008020
M24x150		150	M24		100	7122415010020
M16x190	250	190	M16	60	120	7131619012030
M20x140	203	140	M20	63	150	7132014015030
M20x190	250	190	M20	60	120	7132019012030
M20x190	253	190	M20	63	150	7132019015030
M24x140	200	140	M24	60	120	7132414012030
M24x140	203	140	M24	63	150	7132414015030
M24x190	250	190	M24	60	120	7132419012030
M24x190	253	190	M24	63	150	7132419015030
M30x135	195	135	M30	60	120	7133013512030
M30x135	198	135	M30	63	150	7133013515030

DN	A	B	C	D	E	Article 304
M30x185	245	185	M30	60	120	7133018512030
M30x185	248	185	M30	63	150	7133018515030
M30x235	295	235	M30	60	120	7133023512030
M30x235	298	235	M30	63	150	7133023515030
M36x135	195	135	M36	60	120	7133613512030
M36x135	198	135	M36	63	150	7133613515030
M36x185	245	185	M36	60	120	7133618512030
M36x185	248	185	M36	63	150	7133618515030
M36x235	295	235	M36	60	120	7133623512030
M36x235	298	235	M36	63	150	7133623515030
M16x140	200	140	M16	60	120	7131614012030

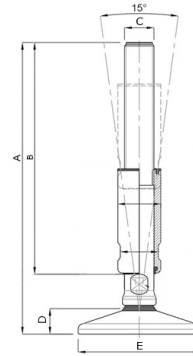

## Article properties

Type	Levelling Feet Hygienic
Certification	3A
Field of application	Food processing, Chemical, Pharmaceutical Industry
Material thread	1.4301 (304)
Material base	1.4301 (304) with EPDM or NBR