

Hygienic 3A stainless steel levelling feet in various designs. Made entirely of stainless steel (1.4301), both wire and base. Available in various diameters and thread sizes.

DN	A	B	C	D	E	Article 304
M12x140	185	140	M12	45	60	7131214006010
M12x190	235	190	M12	45	60	7131219006010
M16x140	185	140	M16	45	60	7131614006010
M16x140	187	140	M16	47	80	7131614008010
M16x140	189	140	M16	49	100	7131614010010
M16x190	235	190	M16	45	60	7131619006010
M16x190	237	190	M16	47	80	7131619008010
M16x190	239	190	M16	49	100	7131619010010
M20x140	185	140	M20	45	60	7132014006010
M20x140	187	140	M20	47	80	7132014008010
M20x140	189	140	M20	49	100	7132014010010
M20x142	189	142	M20	47	80	7132014208010
M20x190	235	190	M20	45	60	7132019006010
M20x190	237	190	M20	47	80	7132019008010
M24x140	187	140	M24	47	80	7132414008010
M24x190	237	190	M24	47	80	7132419008010
M16x140	191	140	M16	51	120	7131614012010
M16x190	241	190	M16	51	120	7131619012010
M20x140	191	140	M20	51	120	7132014012010
M20x140	194	140	M20	54	150	7132014015010
M20x190	239	190	M20	49	100	7132019010010
M20x190	241	190	M20	51	120	7132019012010
M20x190	244	190	M20	54	150	7132019015010
M24x140	189	140	M24	49	100	7132414010010
M24x140	191	140	M24	51	120	7132414012010
M24x140	194	140	M24	54	150	7132414015010
M24x190	239	190	M24	49	100	7132419010010
M24x190	241	190	M24	51	120	7132419012010
M30x135	184	135	M30	49	100	7133013510010
M24x190	244	190	M24	54	150	7132419015010
M30x135	186	135	M30	51	120	7133013512010
M30x135	189	135	M30	54	150	7133013515010
M30x185	234	185	M30	49	100	7133018510010
M30x185	236	185	M30	51	120	7133018512010
M30x185	239	185	M30	54	150	7133018515010
M30x235	286	235	M30	51	120	7133023512010
M30x235	289	235	M30	54	150	7133023515010
M36x135	186	135	M36	51	120	7133613512010
M36x135	189	135	M36	54	150	7133613515010
M36x185	236	185	M36	51	120	7133618512010

DN	A	B	C	D	E	Article 304
M36x185	239	185	M36	54	150	7133618515010
M36x235	286	235	M36	51	120	7133623512010
M36x235	289	235	M36	54	150	7133623515010
M36x235	289	235	M36	26	150	7133623515014
M20x140	194	140	M20	26	200	7132014020014
M20x190	244	190	M20	26	200	7132019020014
M24x140	194	140	M24	26	200	7132414020014
M24x190	244	190	M24	26	200	7132419020014
M30x135	189	135	M30	26	200	7133013520014
M30x185	239	185	M30	26	200	7133018520014
M30x235	289	235	M30	26	200	7133023520014
M36x135	189	135	M36	26	200	7133613520014
M36x185	239	185	M36	26	200	7133618520014
M36x235	289	235	M36	26	200	7133623520014
M16x140	189	140	M16	49	100	7131614010014
M16x140	191	140	M16	51	120	7131614012014
M16x190	239	190	M16	49	100	7131619010014
M16x190	241	190	M16	51	120	7131619012014
M20x140	189	140	M20	49	100	7132014010014
M20x140	191	140	M20	51	120	7132014012014
M20x140	194	140	M20	26	150	7132014015014
M20x190	239	190	M20	49	100	7132019010014
M20x190	241	190	M20	51	120	7132019012014
M20x190	244	190	M20	26	150	7132019015014
M24x140	189	140	M24	49	100	7132414010014
M24x140	191	140	M24	51	120	7132414012014
M24x140	194	140	M24	26	150	7132414015014
M24x190	239	190	M24	49	100	7132419010014
M24x190	241	190	M24	51	120	7132419012014
M24x190	244	190	M24	26	150	7132419015014
M30x135	184	135	M30	49	100	7133013510014
M30x135	186	135	M30	51	120	7133013512014
M30x135	189	135	M30	26	150	7133013515014
M30x185	234	185	M30	49	100	7133018510014
M30x185	236	185	M30	51	120	7133018512014
M30x185	239	185	M30	26	150	7133018515014
M30x235	286	235	M30	51	120	7133023512014
M30x235	289	235	M30	26	150	7133023515014
M36x135	186	135	M36	51	120	7133613512014
M36x135	189	135	M36	26	150	7133613515014
M36x185	236	185	M36	51	120	7133618512014

DN	A	B	C	D	E	Article 304
M36x185	239	185	M36	26	150	7133618515014
M36x235	286	235	M36	51	120	7133623512014

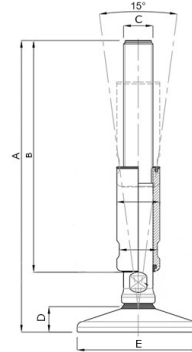

Article properties

Type	Levelling Feet Hygienic SS
Certification	3A
Field of application	Food processing, Chemical, Pharmaceutical Industry
Material thread	1.4301 (304)
Material base	1.4301 (304)