

Article properties

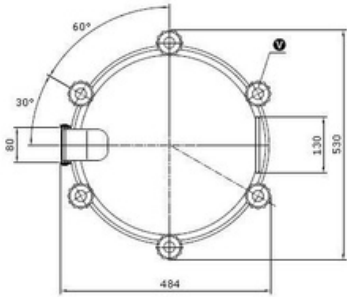
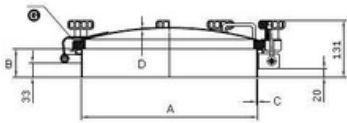

Article	9402.6V252 Round Manhole Cover 6V/252 Cover
Description	opening outwards Material: 1.4307 (304L) Pressure range: +1,2 bar Outside Neck diameter: Ø404mm Tolerance ISO2768 cL: ±2.0mm Welding Neck height: 150mm Welding Neck thickness: 3,0mm Cover thickness: 2,0mm 6x Plastic Handwheel MEC/60 EPDM gasket (FDA)G/6V250 Finish Neck: Grinded/Pickled Finish Cover: Electropolished
Name	6V/252 (Neck 150x3) 304
Type	6V250
DN	DN400
A	404
B	150
C	2
D	2
E	1,2 bar

Round Manhole Cover 6V/252 Cover opening outwards Material: 1.4307 (304L) Pressure range: +1,2 bar Outside Neck diameter: Ø404mm Tolerance ISO2768 cL: ±2.0mm Welding Neck height: 150mm Welding Neck thickness: 3,0mm Cover thickness: 2,0mm 6x Plastic Handwheel MEC/60 EPDM gasket (FDA)G/6V250 Finish Neck: Grinded/Pickled Finish Cover: Electropolished