

Article properties

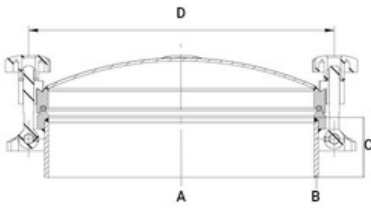

Article	9410.341104-02
Description	Pressure manlid DN400 Design Swift / MQ-Line Inner neck diameter: 409mm Tolerance ISO2768 cL: ±1.0mm Mat. wetted parts: 1.4404 Mat. external parts: 1.4301 Working Pressure: -1 / +1 bar Temperatuur: 0 / +150° Celsius Neck height incl.flange: 100mm Cover thickness: 4,4mm Welding neck thickness: 6mm WITHOUT gasket 4x Plastic handwheel M16 Hinge/Grip: Yes/Yes Brackets welded inside Inside: Not Polished / Pickled Outside: Not Polished / Pickled Design Code: ASME VIII-DIV 1:2017 Design Code: EN13445-3:2016 According Drawing Swift SFG4004716NF-2 Incl. 3.1-Certificaten
Material	1.4404
DN A B	DN400
C D	400
	6
	100
	460

Pressure manlid DN400 Design Swift / MQ-Line Inner neck diameter: 409mm Tolerance ISO2768 cL: ±1.0mm Mat. wetted parts: 1.4404 Mat. external parts: 1.4301 Working Pressure: -1 / +1 bar
Temperatuur: 0 / +150° Celsius Neck height incl.flange: 100mm Cover thickness: 4,4mm Welding neck thickness: 6mm WITHOUT gasket 4x Plastic handwheel M16 Hinge/Grip: Yes/Yes Brackets welded inside Inside: Not Polished / Pickled Outside: Not Polished / Pickled Design Code: ASME VIII-DIV 1:2017 Design Code: EN13445-3:2016 According Drawing Swift SFG4004716NF-2 Incl. 3.1-Certificaten