

Article properties

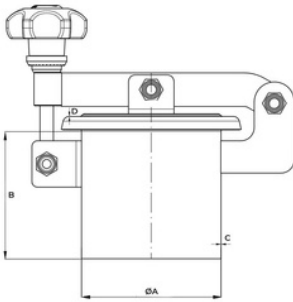

| | |
|-------------|--|
| Article | 9402.T1/100B |
| Description | Round Inspection Cover T1/100/B Opening outwards: hinge/swivel Material: 1.4404 (316L) Pressure range: +0,0 bar Outside Neck diameter: Ø104mm Tolerance ISO2768 cL: ±1.2mm Welding Neck height: 100mm Welding Neck thickness: 2,0mm Cover thickness: 1,5mm 1x Plastic Handwheel MEC/60 EPDM gasket (FDA) GT/100 Finish Neck: Grinded/Pickled Finish Cover: Electropolished T1/100 (Neck 100x2) 316 |
| Name | 1.4404 |
| Material | T1/100 |
| Type | DN100 |
| DN A B | 104 |
| C D | 100 |
| | 2 |
| | 1,5 |

Round Inspection Cover T1/100/B Opening outwards: hinge/swivel Material: 1.4404 (316L) Pressure range: +0,0 bar Outside Neck diameter: Ø104mm Tolerance ISO2768 cL: ±1.2mm Welding Neck height: 100mm Welding Neck thickness: 2,0mm Cover thickness: 1,5mm 1x Plastic Handwheel MEC/60 EPDM gasket (FDA) GT/100 Finish Neck: Grinded/Pickled Finish Cover: Electropolished